

A Taste of the Danube

Eastbound River Cruise Vienna to Budapest

9 DAYS: Friday, April 12-Saturday, April 20, 2019

Discover the fascinating and scenic Danube with its charming small towns and exciting cities on this European river cruise vacation. Begin with a guided sightseeing tour and a 2-night city stay in Vienna, the “City of Music.” Savor Sachertorte in a local café, spend time in one of the many marvelous museums, shop along the Kärntnerstrasse, or stroll along the historic streets. You’ll board your ship and begin exploring the natural beauty of Austria’s Wachau Valley. Enjoy the serene atmosphere as you glide along the river, passing quaint villages and scenic beauty of your Danube River cruise. Visit Melk’s impressive and breathtaking Benedictine Abbey, see Dürnstein’s baroque Stiftskirche, and enjoy guided sightseeing in Slovakia’s vibrant capital of Bratislava. Your journey concludes with two overnights in exciting Budapest, including guided sightseeing and time to explore on your own. Enjoy Hungarian cuisine, explore the famous produce market—Central Market Hall, wander around the former Royal Palace grounds, explore Budapest's famous churches, or just sit back and relax. It’s all available on this grand vacation!



ITINERARY

Day 1 Overnight flight from Boston

Day 2 Arrive Vienna: Welcome to Vienna

Day 3 Vienna: Choice of early risers guided tour, or guided sightseeing

Day 4 Vienna (Embarkation): Morning at leisure; onboard welcome reception

Day 5 Melk–Wachau Valley–Dürnstein: Guided visit of the Benedictine Abbey in Melk; scenic cruising through the Wachau Valley; free time in Dürnstein

Day 6 Bratislava: Guided sightseeing, visit St. Martin's Cathedral
Day 7 Budapest (Disembarkation): Guided tour, see Heroes' Square
Day 8 Budapest: Day at leisure
Day 9 Budapest: Your vacation ends this morning
Return flight to Boston, or opt for an additional day

Avalon has designed **included activities** with a choice of experiences. We invite you to select the tours, activities, and events that interest you most, so you can experience your cruise your way. There are 3 types of included shore excursion on every Europe cruise:

Classic

Your local expert is ready to guide you through the history and heritage of local destinations. You'll marvel at the legends, lore, and spectacular architecture of iconic and historic sites.

Discovery

We've found inspiring and interactive activities to speak to your interests - from cooking classes, to painting workshops - to immerse yourself in each culture you explore.

Active

Embark on energetic excursions to keep you in motion and on the go - from a guided jogging tour of Amsterdam, to biking, paddling, and hiking your way through scenic locales.

Day-By-Day Itinerary

(B) = Breakfast (L) = Lunch (D) = Dinner

Day 1 Overnight flight from Boston

Day 2 Arrive VIENNA, transfer to hotel

Welcome to Vienna Spend free time today by relaxing, exploring, or strolling through the streets of Vienna.

Day 3 (B) VIENNA A Feast for the Soul in Vienna

Classic

Venture into the Habsburg empire with a morning Guided City Tour of Vienna's gilded landmarks. See the Imperial Palace complex—the winter residence of the Imperial Family, the historic Vienna Opera House and stunning St. Stephen's Cathedral, OR:

Discovery

Take an Early Riser Walking Tour that includes breakfast at a Viennese café followed by an exclusive viewing of the Habsburg family's private art collection at the Museum of Fine Arts—the perfect start to your stay in Vienna.

You may also choose to attend an Optional Excursion to a Royal Waltz Concert for an unforgettable evening of music in an elegant hall.

Day 4 (B, D) VIENNA (EMBARKATION) Vienna Favorites—Sachertorte and Apfelstrudel

Enjoy a free day to explore the city at your own pace before boarding your Avalon Suite Ship®

Choose an Optional Guided Hiking or Biking Tour through the vineyards for an active city and countryside excursion.

Or perhaps take a tram ride to discover the adventure, tradition, and Viennese charm of The Prater amusement park. You may also consider to visiting one of Vienna's marvelous museums. Or indulge your sweet tooth with authentic Austrian pastries in a local bakery.

EVENING/OVERNIGHT CRUISE TO MELK

Day 5 (B, L, D) MELK Ornate Architecture and Scenic Splendors Awaken the Imagination and the Senses

Classic

Join a morning Guided Sightseeing Tour of Melk's 11th-century Benedictine Abbey. Explore its frescoes, statues, library, and spectacular pipe organ in the monastery's lofty perch above the Danube.

Take a relaxing break on the Sky Deck as you sail through awe-inspiring views through the Wachau Valley and the wine region surrounding Dürnstein.

DÜRNSTEIN Idyllic Vistas and Vineyards Beyond the Blue Stiftskirche

Spend free time in Dürnstein at your leisure, biking through the vineyards in the Wachau Valley, or hiking up the hillside to castle ruins and breathtaking views.

OVERNIGHT CRUISE TO BRATISLAVA

Day 6 (B, L, D) BRATISLAVA, SLOVAKIA Castles, Vineyards, and Cosmopolitan Culture

Classic

Join a Guided Sightseeing Tour of Old Town's cobblestone streets to Town Hall. Visit the gothic halls of St. Martin's Cathedral—Hungary's centuries-old coronation church.

Alternatively, in your free time take a bicycle and a picnic from the ship to explore the local sights along the Danube. Later, enjoy onboard entertainment by local musicians.

EVENING/OVERNIGHT CRUISE TO BUDAPEST

Day 7 (B) BUDAPEST, HUNGARY (DISEMBARKATION) Time for Cobblestones, Coffee, and Confections

Classic

Take a Guided Sightseeing Tour to see majestic Heroes' Square and Budapest's classic sites.

Day 8 (B) BUDAPEST

Hungarian Dishes, Healing Waters, and Historic Wonders With plenty of free time this afternoon, experience the curative waters of Budapest's thermal baths, or set out for a hike to explore the countryside on either side of the Danube. Take time to shop for treasures, including handcrafted embroidery, Herend porcelain, or Budapest's best baked goods.

Day 9 (B) BUDAPEST

Your vacation ends with breakfast this morning.

Notes

- In the event of water level problems or any problems of a technical nature, it may be necessary to operate the itinerary by motorcoach or to alter the program.
- Included visits and special features are subject to change. If a change becomes necessary, a substitute will be offered.
- Please check visa requirements with your local consulate(s); the responsibility for obtaining a visa rests with the traveler.

Always Included

You've always forged your own path...with your own distinct perspective of looking at the world. Avalon Waterways presents a river cruise experience with your unique style in mind—offering expansive views and wider perspectives. That's why we've designed a cruise experience that's just a bit different.

Throughout the Ship:

- Complimentary Wi-Fi
- Panoramic windows
- Elegant, contemporary design & decor
- Friendly, English-speaking crew & Cruise Director
- Sky Deck with whirlpool, shade awnings, game area and premium lounges
- Covered Observation Lounge
- Club Lounge with 24-hour self-serve beverage station with complimentary cappuccinos, lattes, tea, hot chocolate & premium coffees, as well as treats throughout the day

Suites & Staterooms:

- Comfort Collection BedsSM with choice of mattress firmness
- Egyptian super-combed cotton linens
- Bathrobes & slippers
- Premium L'Occitane bath products
- Large bathroom featuring shower with glass door
- Flatscreen satellite TV with free movie channels
- Individual climate control and in-room safe
- Complimentary bottled water daily

Health & Fitness:

- Bikes
- Canoe, kayak and jogging excursions
- Maps for hiking, biking and jogging routes
- Fitness and wellness activities
- Fitbits®
- All through your Avalon Adventure HostSM

Dining

- FlexDiningSM for more venue and seating options, including flexible seating times in our main Dining Room
- Avalon FreshSM healthy cuisine options at every meal
- Complimentary sparkling wine with breakfast; wine, beer, or soft drinks with every lunch and dinner
- Early and Late Riser breakfast options
- Daily full buffet breakfast with made-to-order egg station, hot and cold menu items
- Daily lunch buffet with pasta or carving stations
- Alternative light lunch or Sky Grill on the Sky Deck (weather permitting)
- Daily Afternoon Tea featuring tea, coffee, sweet treats & sandwiches

- Daily four-course a la carte dinner in the main Dining Room with choice of appetizers, soups, salads, entrees and desserts. Includes selections of regional recipes, Western dishes and vegetarian options.
- Alternative Panorama Bistro dinner, featuring regional specialties and small plates
- Captain's welcome & farewell receptions and dinners with sparkling wine and canapés
- Panorama Lounge featuring premium spirits and Avalon specialty cocktails, along with local entertainment special guests
- Cocktails available on the Sky Deck
- Fresh fruit available throughout the day

Illumination

Part of Avalon's cutting-edge fleet of Suite Ships®, the Avalon Illumination came onto the river cruising scene with a bang. This gorgeous ship features two full decks of Panorama SuitesSM with Wall-to-Wall Panoramic Windows that transform the living space into a unique Open-Air BalconySM. With 200 square feet, Panorama SuitesSM are more than 30% larger than the industry standard, affording you the incomparable opportunity to wake each morning facing the splendid passing scenery. Onboard amenities include an alternative light dining option in the Panorama Bistro, a Fitness Center, complimentary Wi-Fi access, and a spacious Sky Deck with premium lounge chairs, whirlpool, and light al fresco lunches at the Sky Bistro on the Sky Deck.

Included Amenities

- Complimentary Wi-Fi throughout the ship
- Panoramic windows throughout the ship
- Elegant, contemporary design & decor
- Friendly, English-speaking crew & Cruise Director
- Sky Deck with whirlpool, shade awnings, game area and premium lounges
- Covered Observation Lounge
- Club Lounge with 24-hour self-serve beverage station with complimentary cappuccinos, lattes, tea, hot chocolate & premium coffees, as well as treats throughout the day
- Elevator
- Non-smoking interior and staterooms
-

Fitness & Wellness

- Fitness Center
- Avalon Adventure Center
Your place for active gear and excursions, including

Bikes, Canoe, kayak and jogging excursions, Maps for hiking, biking and jogging routes, Fitness and wellness activities, FitBits®

- All through your Avalon Adventure HostSM
- Active shore excursions, both included and optional

Avalon Panorama Suites & Staterooms

- Open-Air BalconiesSM and Wall-to-Wall Panoramic Windows in all Panorama Suites
- Comfort Collection BedsSM with choice of mattress firmness
- Egyptian super-combed cotton linens
- Bathrobes & slippers
- Premium L'Occitane bath products & hairdryer
- Large bathroom featuring shower with glass door
- Wide selection of free movie channels and English-speaking TV
- Individual climate control and in-room safe
- Full-size closet and mirror
- Additional under-bed storage
- Complimentary bottled water daily

STATEROOMS & SUITES

Avalon Deluxe Stateroom (Cat. D, E) - 172 sq. ft.



Features

- Comfort Collection BedsSM
- Egyptian super-combed cotton linens
- Soft & firm pillows
- Choice of bed configuration
- Bedside tables with reading lamps
- L'Occitane bath products
- Easy under-bed luggage storage
- Alarm clock
- Bathrobes & slippers
- Complimentary bottled water
- Individual climate control
- Large mirror in bathroom
- Two windows
- Writing desk and chair
- Luxurious mattress toppers
- European-style duvets
- Extra blankets
- Nightly turn-down service
- Hairdryer
- Spacious 3-door closets with shelves for ample storage
- Flatscreen satellite TV with English-speaking channels & over 100 free movie options
- Direct-dial telephone
- Well-stocked minibar
- In-room safe
- Elegant, contemporary design
- Complimentary Wi-Fi
- Full shower with glass door
- Vanity and lighted makeup mirror

Panorama Suite (Cat. A, B, P) - 200 sq. ft.

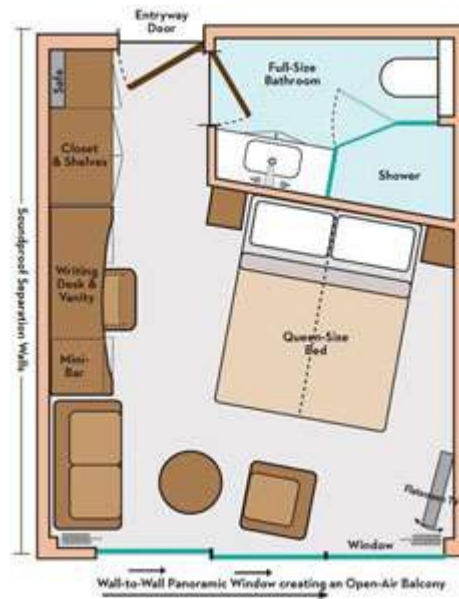

Features

- Comfort Collection BedsSM
- Egyptian super-combed cotton linens
- Soft & firm pillows
- Choice of bed configuration
- Bedside tables with reading lamps
- L'Occitane bath products
- Easy under-bed luggage storage
- Alarm clock
- Direct-dial telephone
- Well-stocked minibar
- In-room safe
- Elegant, contemporary design
- Marble countertops in bathroom
- Wall-to-Wall Panoramic Window with Open-Air BalconySM
- Full shower with glass door
- Vanity and lighted makeup mirror
- Coffee table
- Luxurious mattress toppers
- European-style duvets
- Extra blankets
- Nightly turn-down service
- Hairdryer
- Spacious 3-door closets with shelves for ample storage
- Flatscreen satellite TV with English-speaking channels & over 100 free movie options
- Make-up mirror
- Bathrobes & slippers
- Complimentary bottled water
- Individual climate control
- Large mirror in bathroom
- Complimentary Wi-Fi
- 6-person sitting area
- Writing desk and chair
- Sofa

Royal Suite - 300 sq. ft.

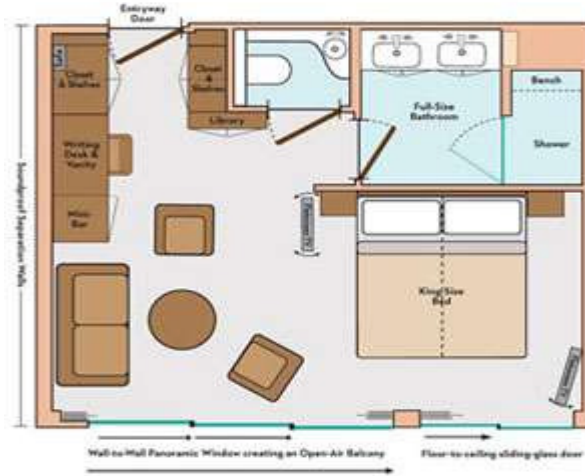

Features

- Comfort Collection BedsSM
- Egyptian super-combed cotton linens
- Soft & firm pillows
- Choice of bed configuration
- Bedside tables with reading lamps
- L'Occitane bath products
- Easy under-bed luggage storage
- Alarm clock
- Direct-dial telephone
- Well-stocked minibar
- In-room safe
- Elegant, contemporary design
- Marble countertops in bathroom
- Wall-to-Wall Panoramic Window with Open-Air BalconySM
- Full shower with glass door
- Vanity and lighted makeup mirror
- Coffee table
- Luxurious mattress toppers
- European-style duvets
- Extra blankets
- Nightly turn-down service
- Hairdryer
- Spacious 3-door closets with shelves for ample storage
- Flatscreen satellite TV with English-speaking channels & over 100 free movie options
- Make-up mirror
- Bathrobes & slippers
- Complimentary bottled water
- Individual climate control
- Large mirror in bathroom
- Complimentary Wi-Fi
- 6-person sitting area
- Writing desk and chair
- Sofa
- Double sinks

DECK PLANS

SKY DECK



ROYAL DECK



SAPPHIRE DECK

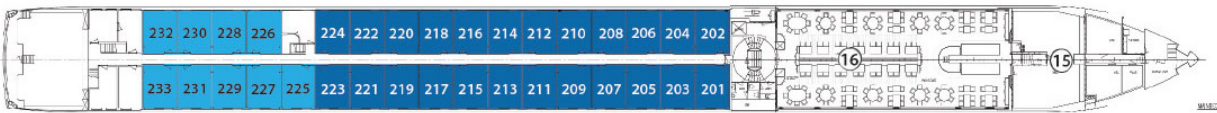

INDIGO DECK

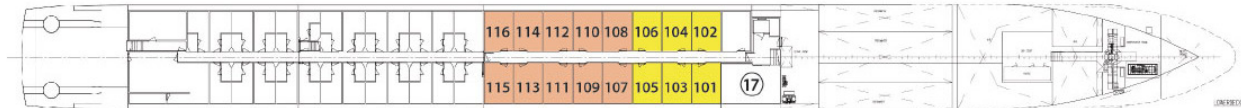

DECK PLAN

- | | | |
|---|----------------------|-------------------|
| 1 Sky Lounge | 6 Deck Game Area | 12 Elevator |
| 2 Navigation Bridge | 7 Observation Lounge | 13 Lobby |
| 3 Sky Grill | 8 Panorama Bistro | 14 Club Lounge |
| 4 Whirlpool | 9 Panorama Lounge | 15 Galley |
| 5 Premium Lounge
Chairs and Shade
Awnings | 10 Bar | 16 Dining Room |
| | 11 Reception | 17 Fitness Center |

CATEGORIES

- Royal Suite Royal Deck | Royal Suites
- Cat. P Royal Deck | Panorama Suites
- Cat. A Sapphire Deck Forward | Panorama Suites
- Cat. B Sapphire Deck Aft | Panorama Suites
- Cat. D Indigo Deck Aft | Deluxe Staterooms
- Cat. E Indigo Deck Forward | Deluxe Staterooms